



LG **One:Quick** Works

All-in-One Video Conferencing Display

for Maximum Productivity



* All images in this datasheet are for illustrative purposes only.

PRODUCT INFORMATION

One:Quick Works (55CT5WJ)

Screen Size	55"	
Native Resolution	4K Ultra HD (3,840 x 2,160)	
Brightness	450 nits	
Camera	4K Ultra HD (3,840 x 2,160), 120° FoV, 4x Zoom, Video Framing, ePTZ	
Microphone	10ea Array, 6m Pickup Range, Beamforming	
Sound	10W + 10W	
Touch	In-Cell Touch (Max. 10 Points)	
HW	CPU	AMD Ryzen Embedded V1605B
	Graphics	AMD Radeon Vega
	eMMC	128GB
	RAM	8GB
	Wi-Fi	802.11ac 2 x 2
	Bluetooth	Bluetooth 5.0
Operating System	Windows 10 IoT Enterprise	

All-in-One Video Conferencing Solution



Video conferencing setup doesn't need to be stressful. This all-in-one solution features a built-in Windows PC, crisp 4K UHD camera, microphone, speaker and a digital whiteboard. Experience clear video and sound qualities in your meetings.

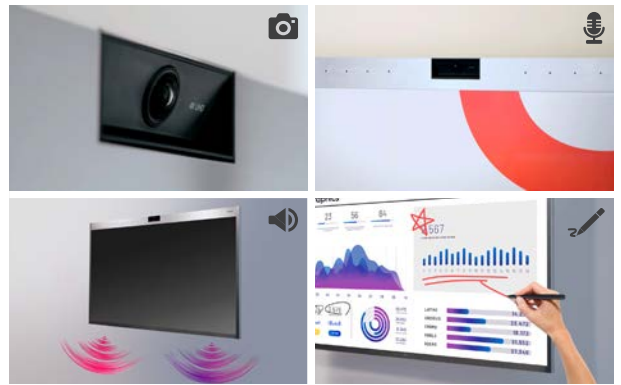

Smart Auto Focusing



Have the camera and mic move to you, not the other way around. One:Quick Works automatically focuses on the speaker and it is effective in clearly capturing voices up to six meters away with minimal background noise, while the 3,840 x 2,160 resolution camera automatically tracks and focuses on the individual speaker.

* Product performance may differ depending on the environment.



Pre-installed Video Conferencing Application, LG One:Quick Remote Meeting



LG's One:Quick Remote Meeting is integrated with the One:Quick Works to easily join virtual rooms without logins or invites. Just click on a virtual meeting room and you're in! Screen share, annotate, share files, and communicate virtually effortlessly all



* All images in this datasheet are for illustrative purposes only.

Easy-To-Use Conference App Store



Shortcuts for installing leading video conferencing and collaboration apps are included to help with user productivity. A true all-in-one video conferencing solution must be able to use a wide variety of video conferencing apps all running on Windows 10 IOT.

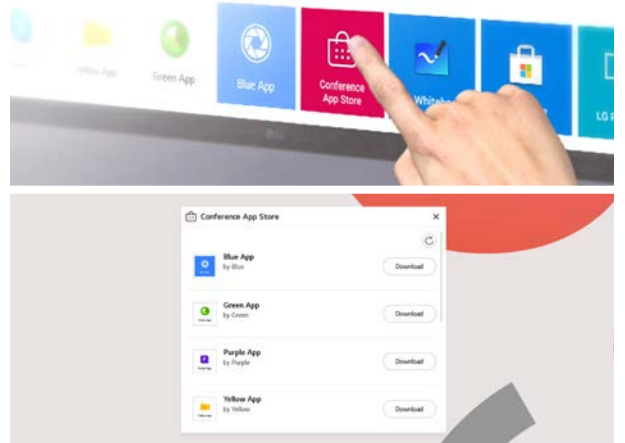

Multi-Touch and Annotation



Equipped with In-cell touch, One:Quick Works turns ideas into reality with 10 points of multi touch. And it conveniently sends files such as notes, writings, drawings and images created in meetings via E-mail.*

* Touch pen provided (1 ea.). Dedicated apps required for making notes and drawings (MS Whiteboard app ready).



Voice Recording



Rather than keeping separate meeting minutes, simply record the meeting and share files with participants via e-mail.

* Voice Recording may not be allowed when using the video conferencing app.

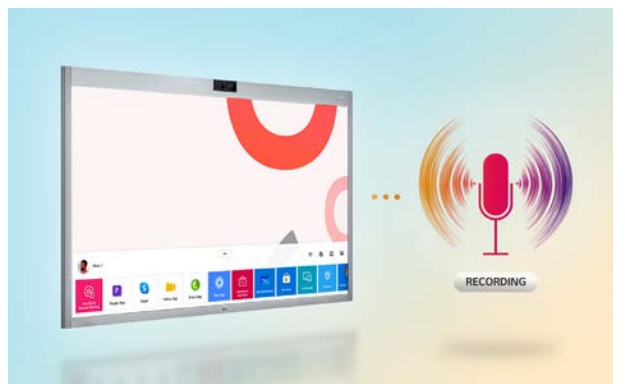

Split View for Multi-Tasking



Share files and organize ideas simultaneously with members in the meeting room. Utilize two applications at once without having to window them.



Optimized User Experience



Provides a user friendly interface, from adjusting network settings for meetings, screen division to display settings. Supports quick and easy access to video conferencing apps with the One:Quick Works launcher.

* SW for adding and deleting apps is scheduled to be updated and will be available in November 2021.

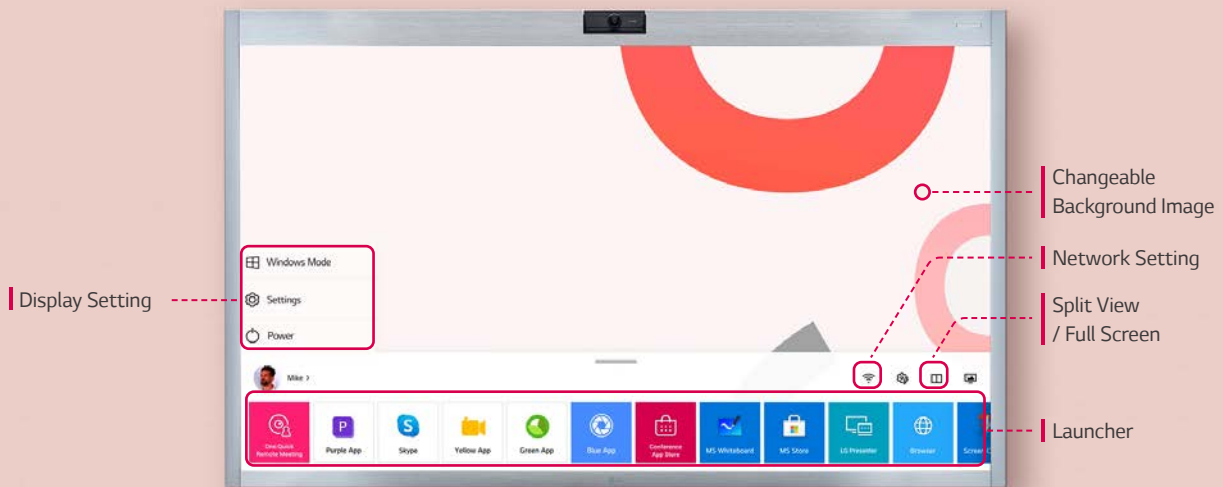
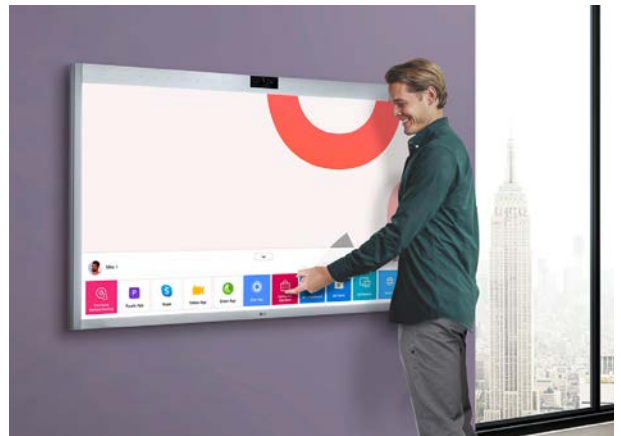

2-way Installation



The One:Quick Works can be installed with a separate wall mount or placed on a table using the included tabletop stands.

Awarded the reddot Award 2021 & iF DESIGN AWARD 2021 for its sleek design



With an impressive award-winning design, the One:Quick Works blends seamlessly with the rest of the workspace. Also brings an elevated aesthetic while providing a practical workspace for all participant.

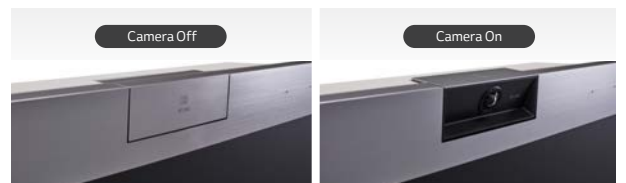
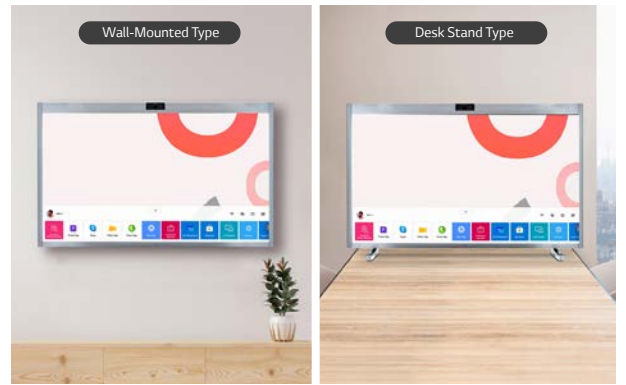

* All images in this datasheet are for illustrative purposes only.

MODEL		55CT5WJ
PANEL	Screen Size	55"
	Panel Technology	IPS In-Cell Touch
	Back Light Type	Edge
	Aspect Ratio	16:9
	Native Resolution	3840 x 2160 (UHD)
	Refresh Rate	60 Hz
	Brightness	450 nits
	Contrast Ratio	1000:1
	Color gamut	NTSC 72%
	Viewing Angle (H x V)	178° x 178°
	Color Depth	10-bit (D), 1.07 Billion colors
	Response Time	9 ms
	Lifetime	50,000 Hrs
	Operation Hours (Hours/Day)	24/7
Portrait / Landscape	Landscape Only	
TOUCHSCREEN	Available Object Size for Touch	Ø8 mm
	Accuracy	less than 3.5mm
	Interface	USB 1.1
	Operating System Support	Windows 7 / 8 / 8.1 / 10 MacOS 10.9 Android 4.4 Linux kernel 3.9
	Multi touch point	MAX 10 Points
CAMERA, MIC & SOUND	Camera Resolution	3840 x 2160 (UHD)
	Camera Field of View (FoV)	120°
	Camera Zoom (ePTZ)	4x Zoom
	Camera Video Framing	Yes
	Mic Array	10EA
	Mic Beamforming	Yes
	Mic Pickup Range	6m
	Built-in Speakers	10W x 2
CONNECTIVITY (WEBOS)	HDMI In	Yes (x2)
	DP In	USB-Type C
	RS232C In	Yes
	RJ45 (LAN)	Yes
	IR In	Yes
	USB 2.0 Type A In	Yes
	RS232C In	Yes
FEATURES (WEBOS)	Built-in Wi-Fi	No
	Temperature Sensor	Yes
	Auto Brightness sensor	Yes
	Acceleration (Gyro) Sensor	No
	Local Key Operation	Jog Key
	Fanless Design	Yes
	Bootimg Logo Image	Yes
	No Signal Image	Yes
	Screen Rotation	Yes
	External Input Rotation	Yes
	Crestron Inside	Yes
	Smart Energy Saving	Yes
	PM mode	Yes
	Wake on LAN	Yes
	HDMI-CEC	Yes
	Bluetooth	Yes
	CONNECTIVITY (WINDOWS)	RJ45 (LAN)
USB Type C In		Yes
USB 3.1 Type A In		Yes (x2)

MODEL		55CT5WJ
FEATURES (WINDOWS)	CPU	AMD Ryzen Embedded V1605B
	Graphics	AMD Radeon Vega
	eMMC	128 GB
	RAM	8 GB
	Wi-Fi	802.11ac 2x2
	Bluetooth	Bluetooth 5.0
	OS	Windows 10 IOT Enterprise
	Launcher Bar	Yes
	Full / Half	Yes
	Cloning	Yes
	Screen Capture	Yes
	Meeting (Voice) Record	Yes
	File Sharing	Yes
	Compatibility One:Quick Share	Yes
LG Remote Meeting	Yes	
Built-in Apps	Chrome, Skype (Preloaded), MS Whiteboard (Download link)	
LG SOFTWARE COMPATIBILITY	SuperSign CMS	Yes
	SuperSign Control / Control+	Yes
	Signage 365 Care	Yes
MECHANICAL	Bezel Color	Silver
	Bezel Width	57.2 / 26.2 / 26.2 / 28.9 mm
	Weight	57.3 lbs / 26 kg
	Weight with Stand	58.6 lbs / 26.6 kg
	Shipping Weight	68.3 lbs / 31 kg
	Dimensions (W x H x D)	49.8 x 30.3 x 2.4 in / 1265 x 769.5 x 61.8 mm
	Dimensions with Floor Stand - Landscape (W x H x D)	49.8 x 32.1 x 11.4 in / 1265 x 815 x 290 mm
	Dimensions with Floor Stand - Portrait (W x H x D)	49.8 x 32.1 x 11.4 in / 1265 x 815 x 290 mm
	Dimensions with Desktop Stand (W x H x D)	49.8 x 32.1 x 11.4 in / 1265 x 815 x 290 mm
	Shipping Dimensions Without Stand	54.0 x 35.6 x 6.6 in / 1372 x 903 x 168 mm
VESA Compatible	300 x 300	
POWER	Power Supply	100-240 Vac, 50 / 60 Hz
	Power Type	Built-In Power
	Power Consumption (Typ.)	195 W / 81 BTU
	Max.	275 W
	DPM	Less than 0.5 W
	Power off	Less than 0.5 W
	WARRANTY & OTHER	Warranty
FCC (Regulatory)	Class "B"	
CE (Regulatory)	Yes	
ErP (Environmental)	Yes	
Energy Star (Environmental)	8.0	
Onscreen Display Languages	English, French, German, Spanish, Italian, Korean, Chinese(Simplified), Chinese(Original), Portugues(Brazil), Swedish, Finnish, Norwegian, Danish, Russian, Japanese, Portugues(Europe), Dutch, Czech, Greek, Arabic, Turkish	
Accessories	Remote Control (includes 2 batteries), Power Cord, Touch Pen, Pen tip, Manual, Warranty Card, Installation Guide	